



MIDTOWN

Streetscape/Traffic Improvements



WHITMAN, REQUARDT & ASSOCIATES, LLP
801 South Caroline St., Baltimore, MD 21231

Community Meeting

February 20, 2014



Project Location

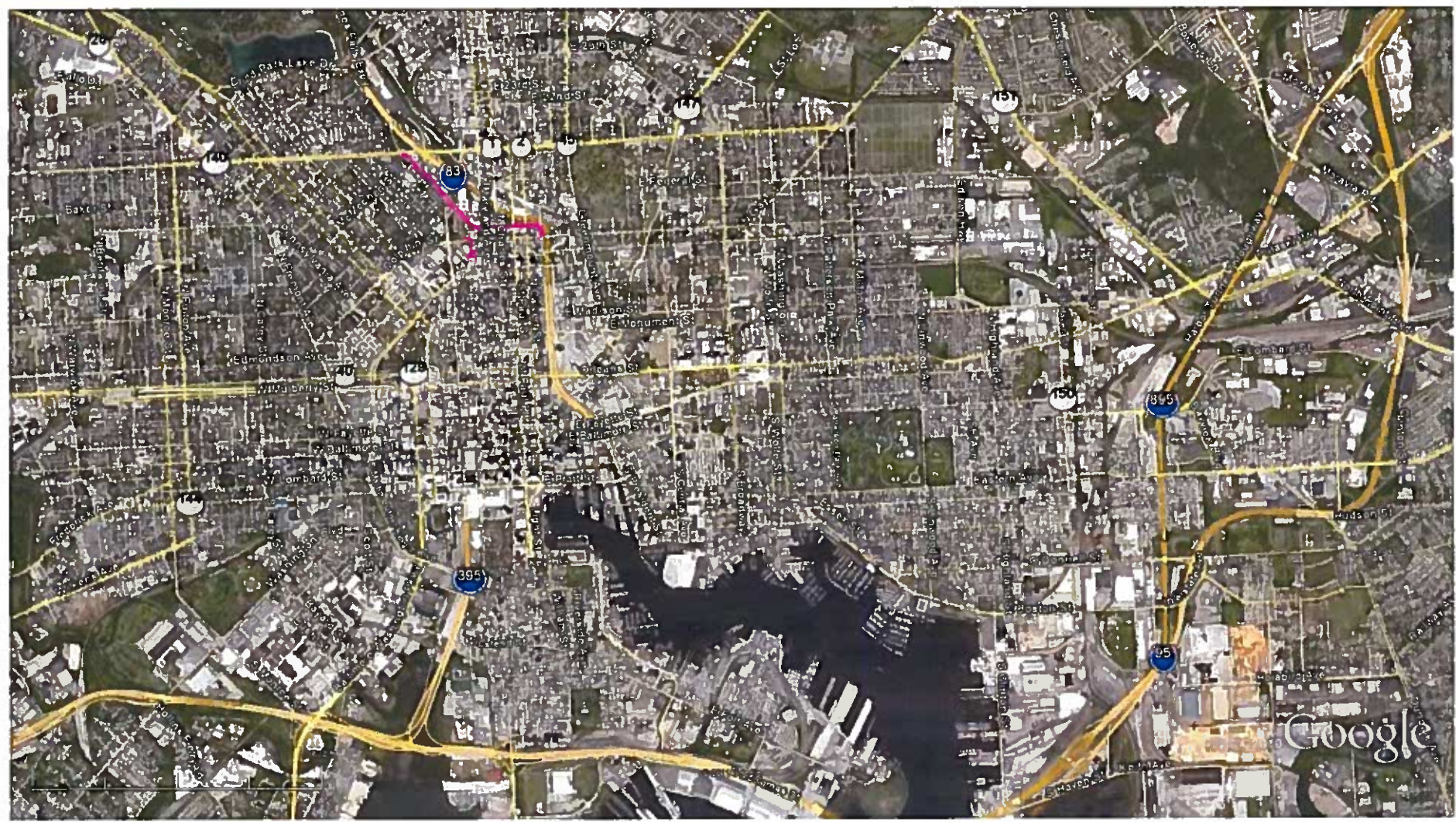

MIDTOWN *Streetscape/Traffic Improvements*



WHITMAN, REQUARDT & ASSOCIATES, LLP
801 South Caroline St., Baltimore, MD 21201



Project Location

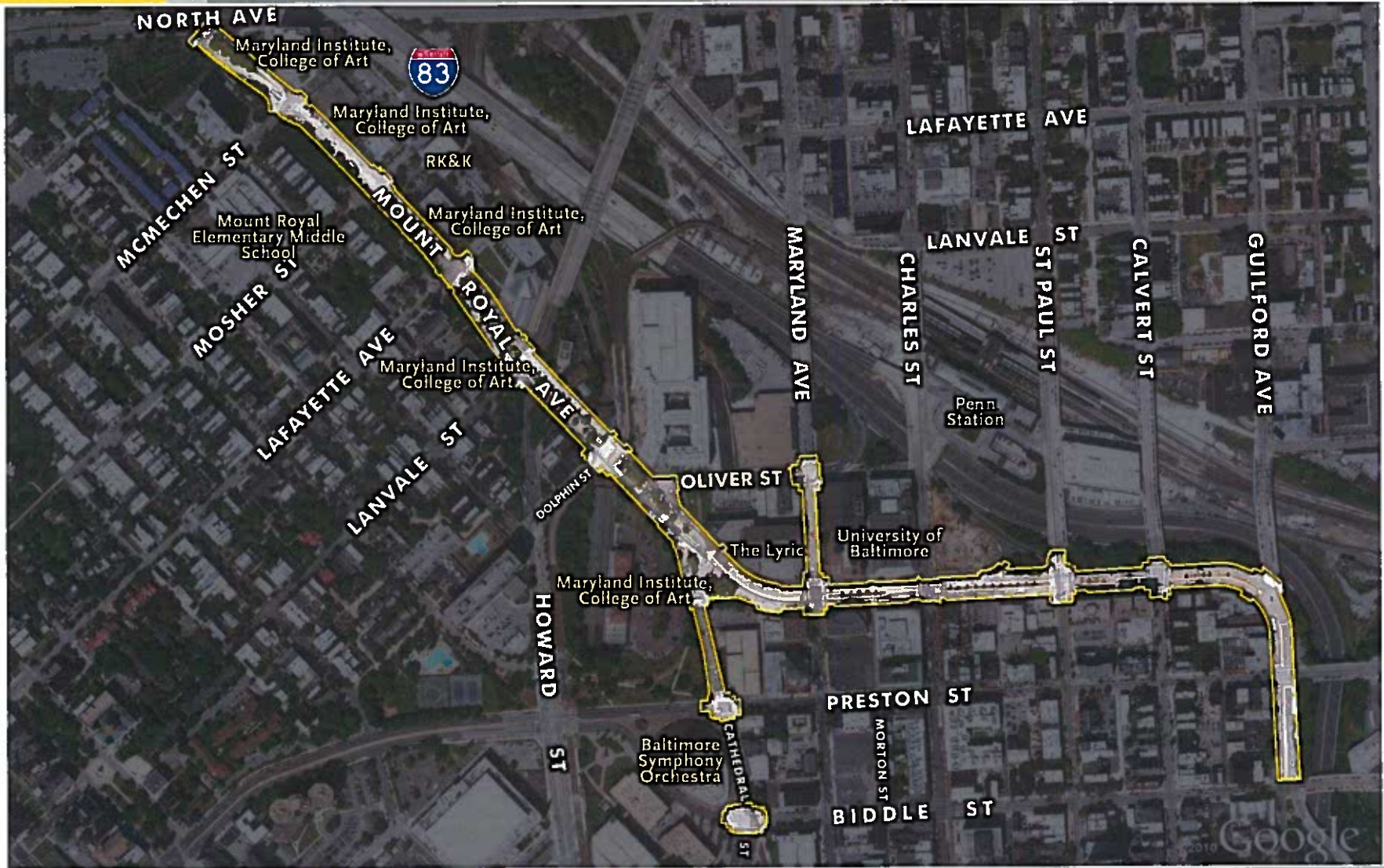

MIDTOWN *Streetscape/Traffic Improvements*



Project Objectives

- Improve Roadway Surface
- Upgrade Pedestrian Ramps for ADA compliance
- Promote Pedestrian Use of Mt. Royal Avenue
- Promote Bicycle Use of Mt. Royal Avenue
- Improve Overall Aesthetic of Midtown
- Upgrade Traffic Signals
- Construct Artscape Conduit
- Water Main Improvements

- *Street Corner Bump-outs*
 - ▶ Shorter Pedestrian Crossing
 - ▶ Traffic Calming
 - ▶ ADA Compliant Ramps
 - ▶ Landscaping Opportunities



- *Traffic Signals*
 - ▶ Ornamental Joint-Use Poles
 - ▶ Audible Pedestrian Pushbuttons
 - ▶ Countdown Pedestrian Signals
 - ▶ ADA Compliance



- *Roadway Improvements*
 - ▶ Milling and Overlay Asphalt roadway
 - ▶ Roadway Base Repair
 - ▶ New Lane and Crosswalk Markings
 - ▶ Roadway Drainage Improvements
 - ▶ Improve Median Aesthetics/Increase Green Space
 - ▶ Sidewalk along Parking Lane – McMechen to Lafayette

- Two-way Cycletrack

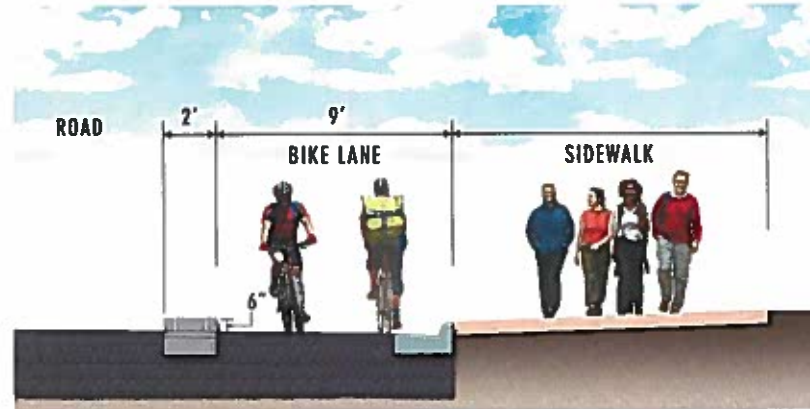



Project Features

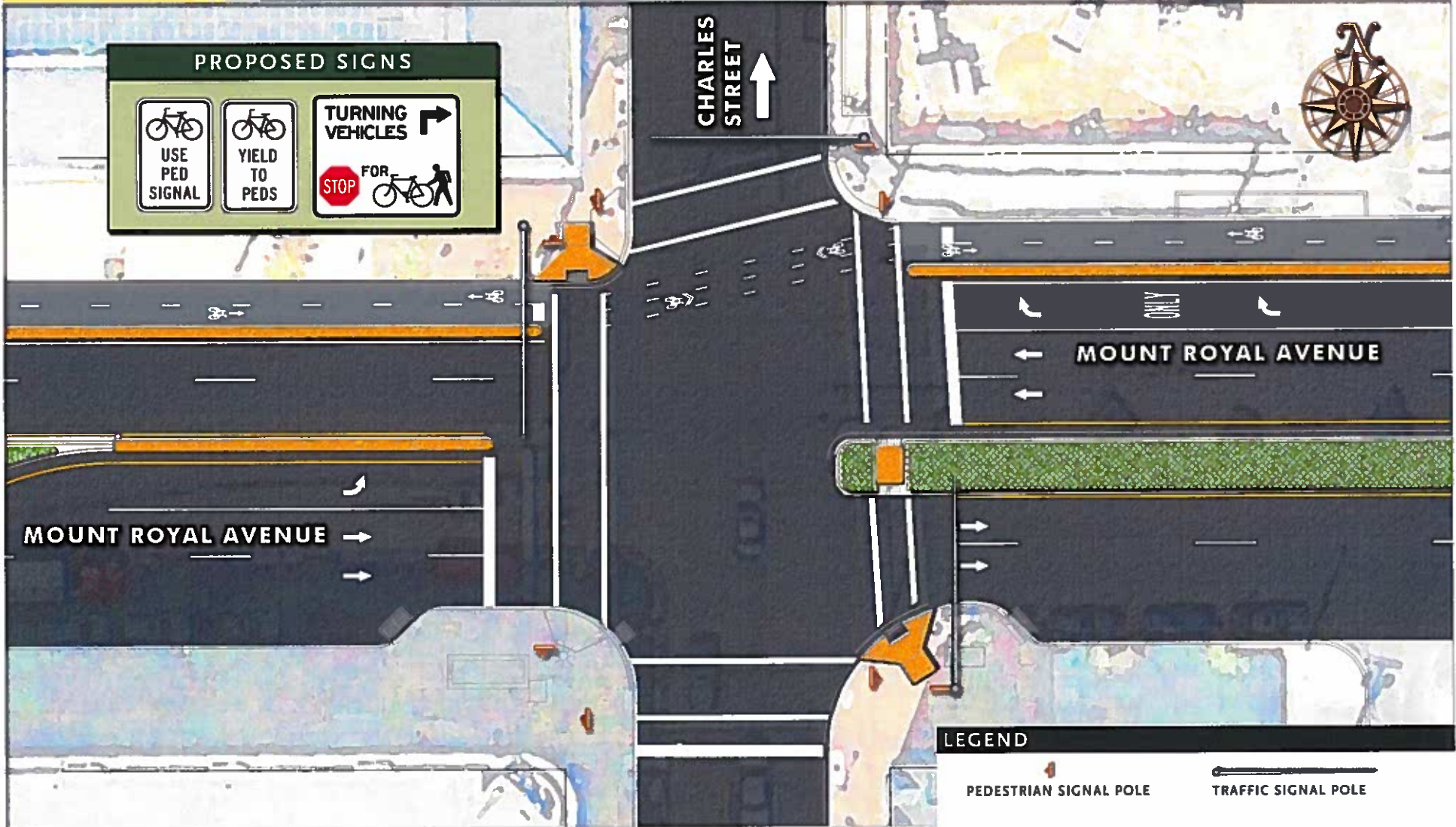

Streetscape/Traffic Improvements

- *Artscape Conduit*
 - Permanent Underground Conduit between Lanvale and Mosher Streets
 - Improve Setup of Artscape
- *Water Main Upgrade*
 - Replace Water Mains – Lafayette to Dolphin





Project Schedule & Budget

- *Schedule*
 - ▶ Complete Design: Fall 2014
 - ▶ Begin Construction: Spring 2015
 - ▶ Construction Duration: 560 Days
- *Budget*
 - ▶ \$6-7 Million

North Avenue to LaFayette Street

LEGEND

- ASPHALT OVERLAY
- RECONSTRUCTED TRAFFIC SIGNAL
- BIKE LANE
- SIDEWALK
- LANDSCAPE
- EXISTING SIGNAL TO REMAIN

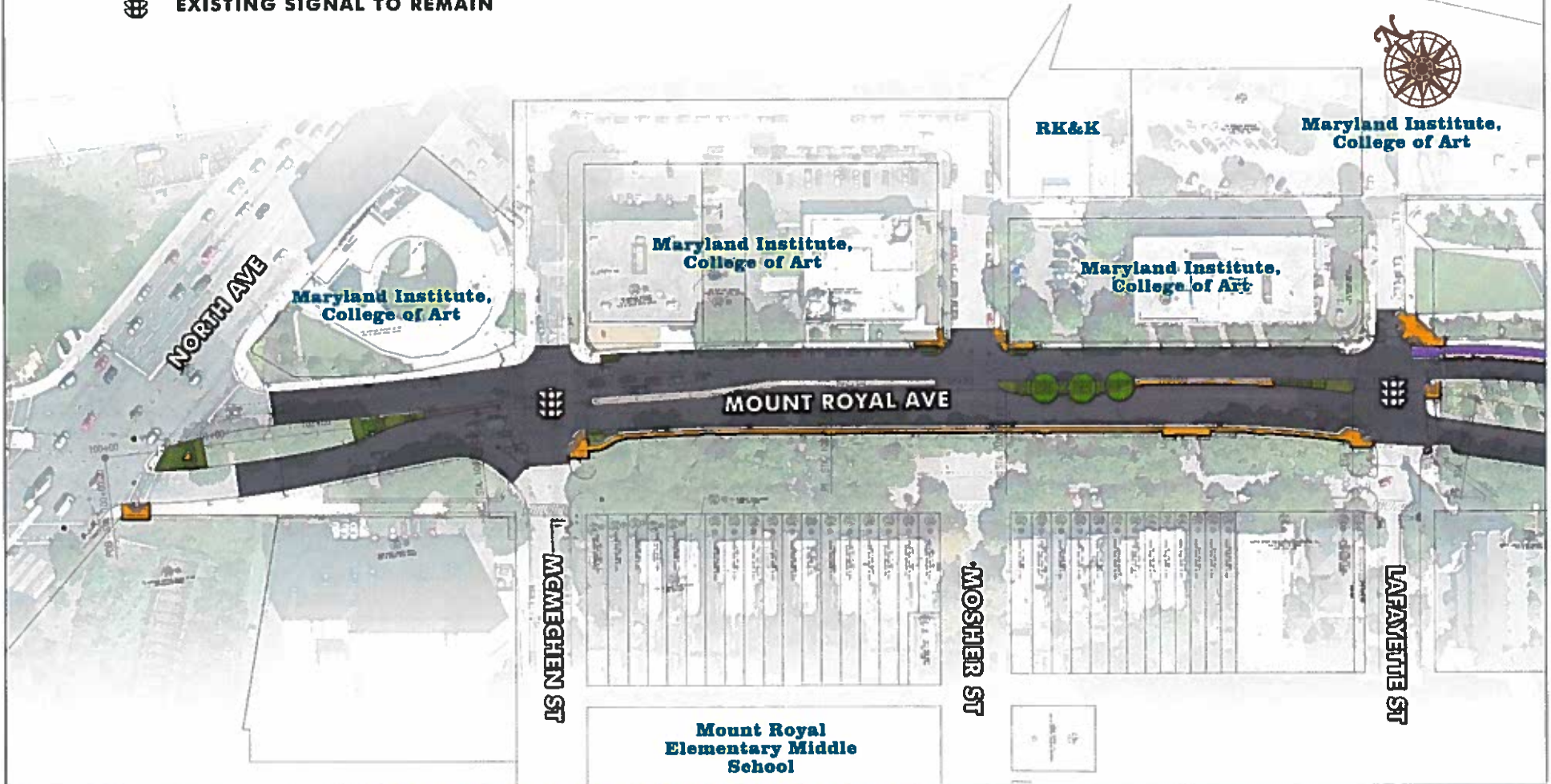

MIDTOWN
Streetscape/Traffic Improvements



LaFayette Street to Oliver Street

LEGEND

- ASPHALT OVERLAY
- RECONSTRUCTED TRAFFIC SIGNAL
- BIKE LANE
- SIDEWALK
- LANDSCAPE
- EXISTING SIGNAL TO REMAIN

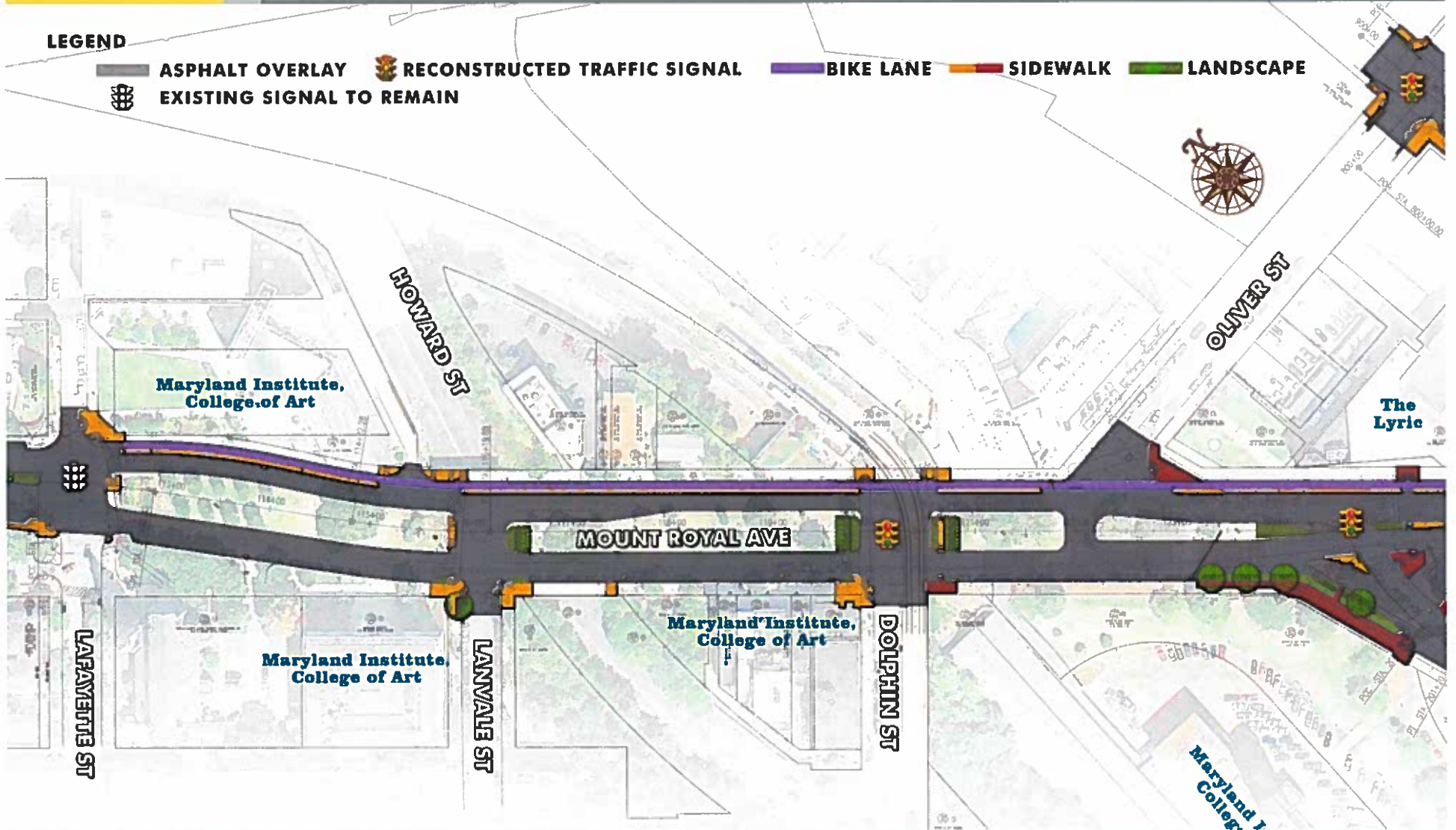

MIDTOWN
Streetscape/Traffic Improvements



Cathedral Street to St. Paul Street

LEGEND

- ASPHALT OVERLAY
- RECONSTRUCTED TRAFFIC SIGNAL
- BIKE LANE
- SIDEWALK
- LANDSCAPE
- EXISTING SIGNAL TO REMAIN

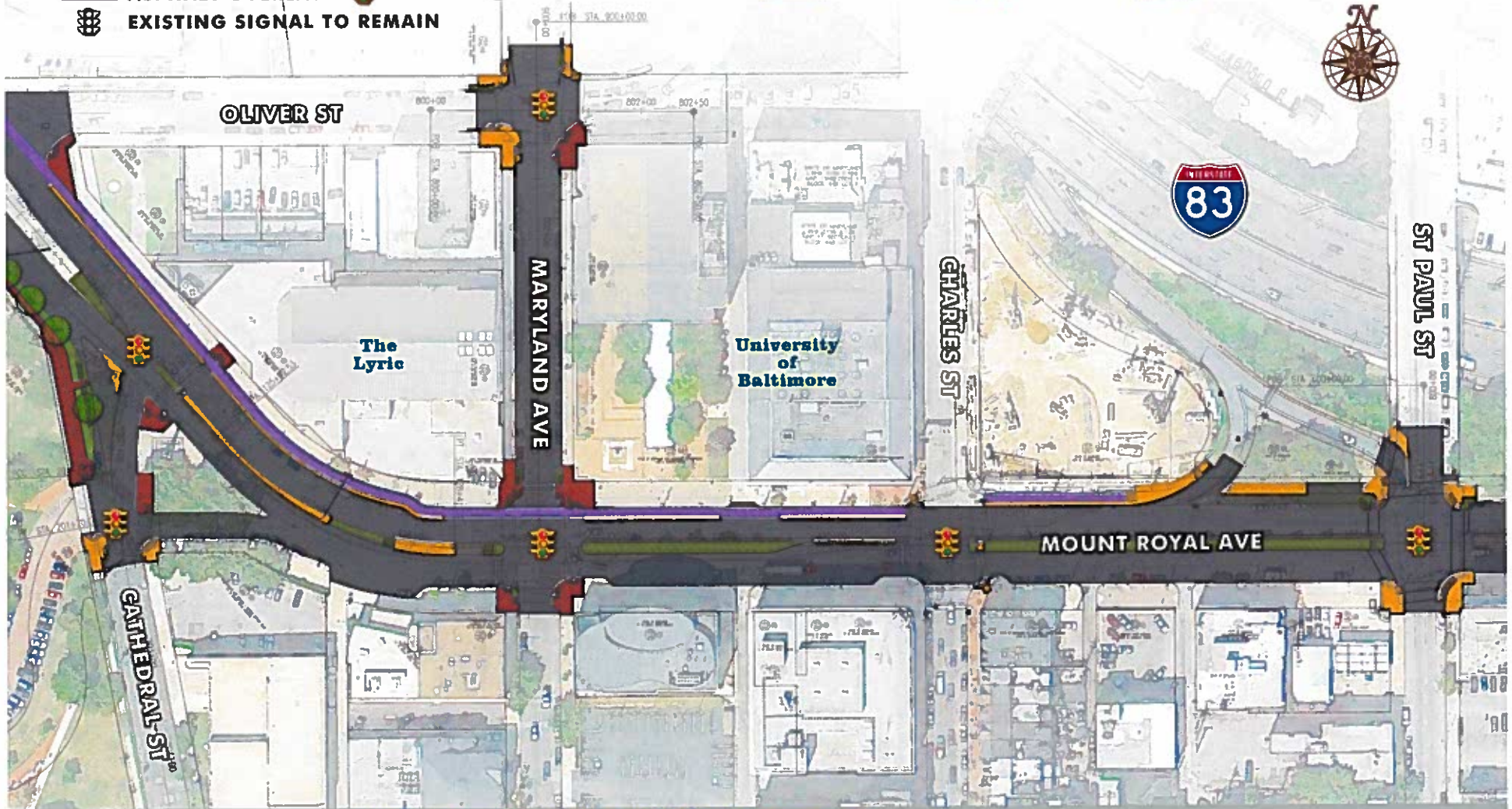

Streetscape/Traffic Improvements

MIDTOWN

St. Paul Street to Guilford Avenue



LEGEND

-  ASPHALT OVERLAY
-  RECONSTRUCTED TRAFFIC SIGNAL
-  BIKE LANE
-  SIDEWALK
-  LANDSCAPE
-  EXISTING SIGNAL TO REMAIN

Streetscape/Traffic Improvements

St. Paul Street to Guilford Avenue

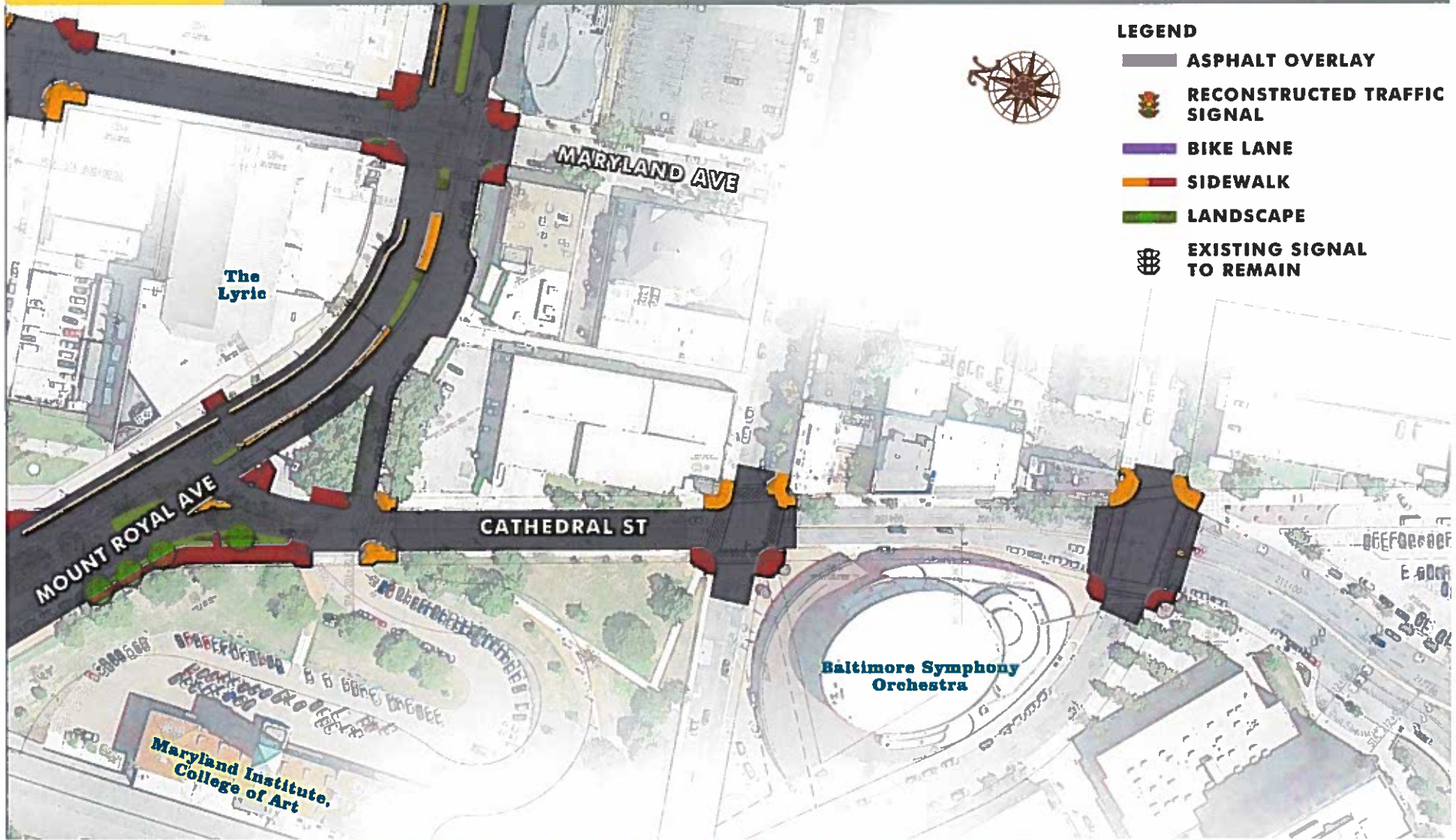

MIDTOWN
Streetscape/Traffic Improvements

Project Location

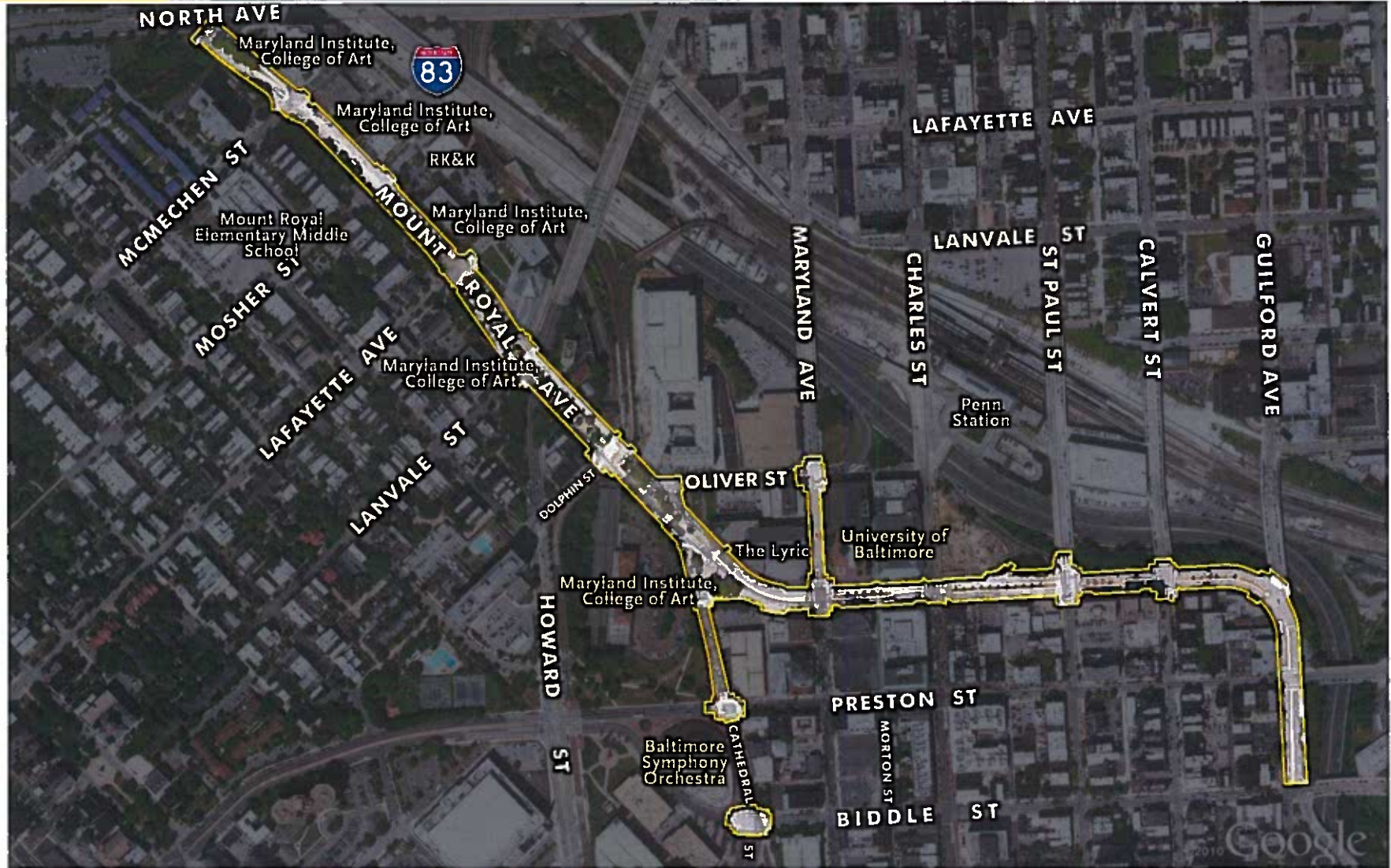

MIDTOWN
Streetscape/Traffic Improvements